

TBIT Construction News



The focus of this months newsletter is the pending shutdowns of the power and communication systems that impact the TBIT Community.

Power & Communication Relocations

Inside this issue:

- Core Temporary Emergency Egress **2**
- Communication Ductbank Relocation **3**
- East Egress Project **3**
- Gate 123B Closure **3**
- Bradley West Program Schedule **4**
- Interim West Busing Terminal Update **5**
- Gate 106 & 119 Progress **6**
- In-Transit Lounge Impacts **6**
- Construction Photographs **7**

The power and communication lines that run underneath the existing vehicle service road on the west side of TBIT are in the way of the new Bradley West construction. Consequently, all power and communication systems including 4160V circuits, 480V circuits, 400Hz power systems, fire alarm systems and AT&T/SITA systems must be relocated to allow for the excavation and construction of the new Bradley West Core and Concourses. The relocation of these systems will create a significant impact because of the shutdowns required to relocate them. The current shutdown schedule is listed below:

Fire Alarm System

1. June 30 - Complete
 2. July 06 - On Schedule
 3. July 12
 4. July 19
 5. July 26
 6. August 02
 7. August 09
 8. August 16
- Impact - Shutdowns associated with the fire alarm system will have no impacts to terminal, tenant or security operations.

480V Circuits

1. July 09
→ Impact - Normal power to north concourse from 0200 to 0800.
2. July 13
→ Impact - Emergency power to north and south concourses from 0200 to 0500. No impact to airline operations.
3. August 05
→ Impact - Normal power to Gates 101/102 and south gates PCA from 0200 to 0600. No impact to airline operations.
4. August 06
→ Impact - Normal power to south concourse from 0200 to 0800.

4160V Circuits

1. July 16
→ Impact - Normal power to Gates 122/123, north gates PBB, GPU & PCA from 0200 to 0800. No impact to airline operations.

400Hz Power System

1. July 22 & 23
→ Impact - 400 Hz ground power to Gates 104, 105 and 120 from 0200 to 0600. No impact to airline operations.

AT&T—SITA Systems

1. July 19, 20 & 21
→ Impact - North concourse VOIP telephone or SITA systems from 0200 to 0600.
2. July 26, 27 & 28
→ Impact - South concourse VOIP telephone or SITA systems from 0200 to 0600.

Further information including the shutdown work plan, updated schedule and disruption notices will be provided to the TBIT Community for preparation and coordination purposes. In addition LAWA will establish an Incident Command Center (ICC) for the **major shutdowns** to coordinate with all representatives. The ICC shall establish a point of contact to coordinate and facilitate the outage with the affected parties. Contact information for the ICC shall be distributed prior to the shutdown.

Core Temporary Emergency Egress

Core Egress includes the temporary emergency egress from the third floor corridors and fifth floor premium lounges. As the excavation on the west side of TBIT continues for the Bradley West Core, modifications must be made to the existing bus gates and the emergency egress stairs on the outside of the building. Current emergency exits from the bus gates and fifth floor lounges would exit passengers into the construction site and therefore new emergency paths of egress must be established. Emergency egress is a necessary part of the project to provide a safe environment for the traveling public.

On July 1st the bus gate restrooms were closed to accommodate construction of a new stair (Figure 1). Signage was installed to re-direct the passengers to alternate restroom locations at Gates 105 or Gate 120. Construction of the fifth floor egress stairs have minimal impacts to the One World and Star Alliance lounges. One World lounge loses storage (Figure 2) and the Star Alliance break room (Figure 3) is captured for new exit corridors. LAWA properties has worked with both of these alliance lounges to replace this space on the third level of TBIT. Construction on the fifth floor is tentatively schedule for early August.

Note the new emergency egress stairs location and travel path on the drawings. This is a temporary condition and once Bradley West program and central core construction is complete, this space will be returned to the alliance lounges.

“Discontent is the first necessity of progress.”

*--Thomas A. Edison
American Inventor,
Scientist & Businessman*

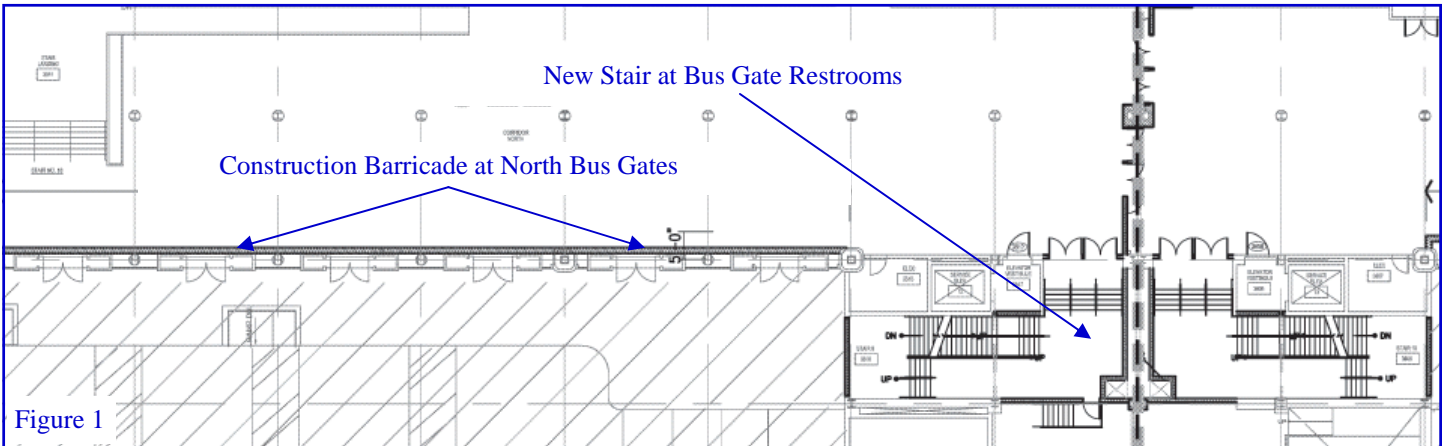

Figure 1

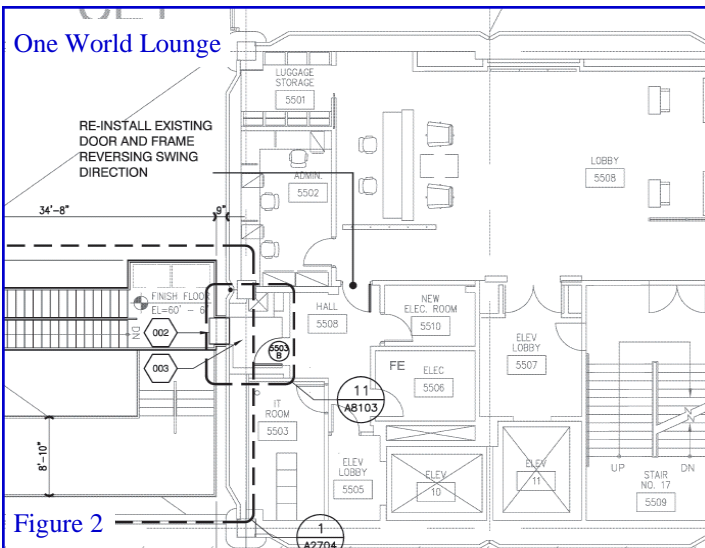

Figure 2

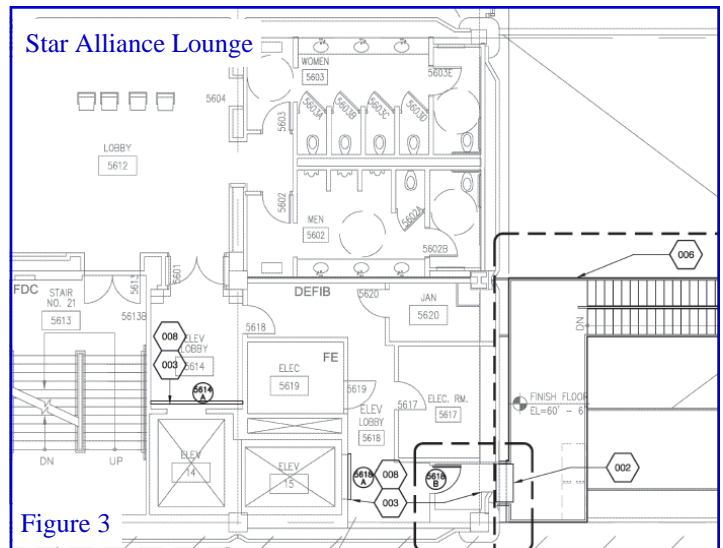

Figure 3

Communication Ductbank Relocation

Similar to the power and communication work as mentioned on the front page, in order to make way for the construction of the Bradley West Core, major communication duct banks on the north and south of the existing TBIT Terminal

need to be relocated. The shutdowns associated with the north duct bank is currently scheduled for July 30th and August 25th for the south. Because of the potential impact of the shutdown, a Stakeholder Coordination Meeting

has been tentatively scheduled for July 15th. The finalized work plan and shutdown schedule will be closely coordinated with the TBIT community. Additional information regarding this shutdown will be forthcoming.

East Egress Project



Previous construction newsletters have detailed the new emergency paths of egress that must be established on the east side of the north and south concourses. Construction of the metal stairs at Gates 119, 120 and 121 are complete and active

of the ACAMS for the new exit doors in the sterile corridor are scheduled for a July 8th operation. The east egress project will switch to the south concourses in July, with scheduled completion in late August.

Gate 123B Closure

Connection of the fire water loop for the Bradley West program is adjacent to Gate 123B and the Interim West Busing Terminal (IWBT). New construction barricades shall be placed between the IWBT and Gate 123B for the contractor to safely complete the work. LAWA Operations has approved the contractor's request for the closure of Gate 123B from 0200 - 1100 daily starting July 7th. LAWA Operations has reviewed the flight schedule and airline operations will **not** be impacted.

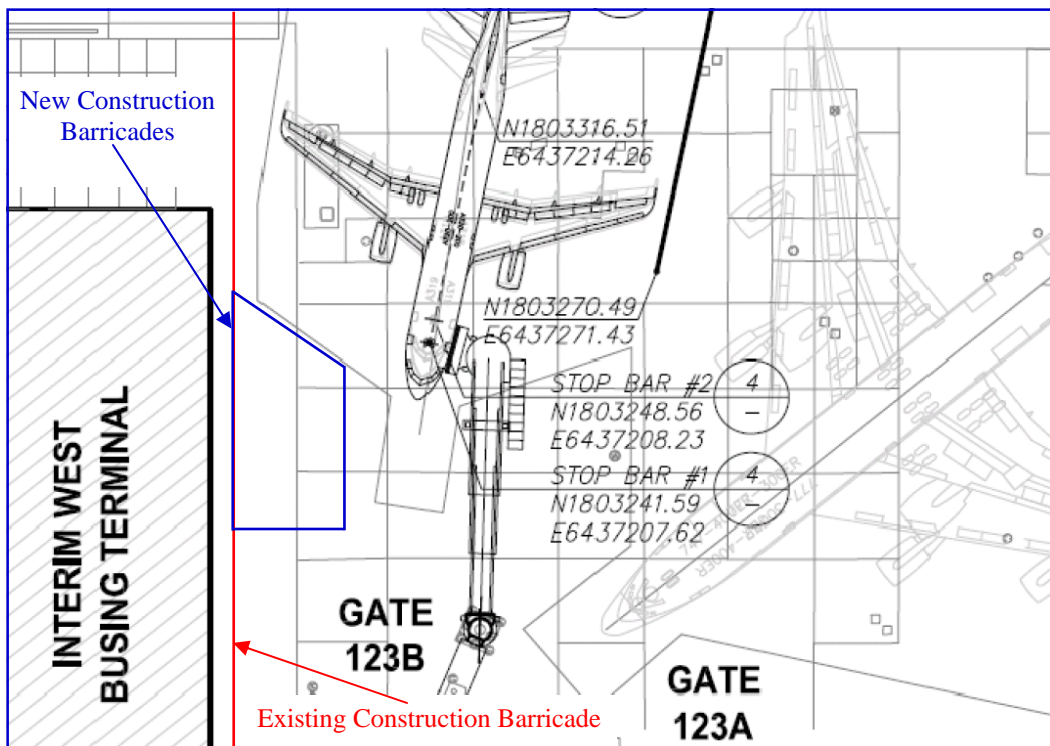

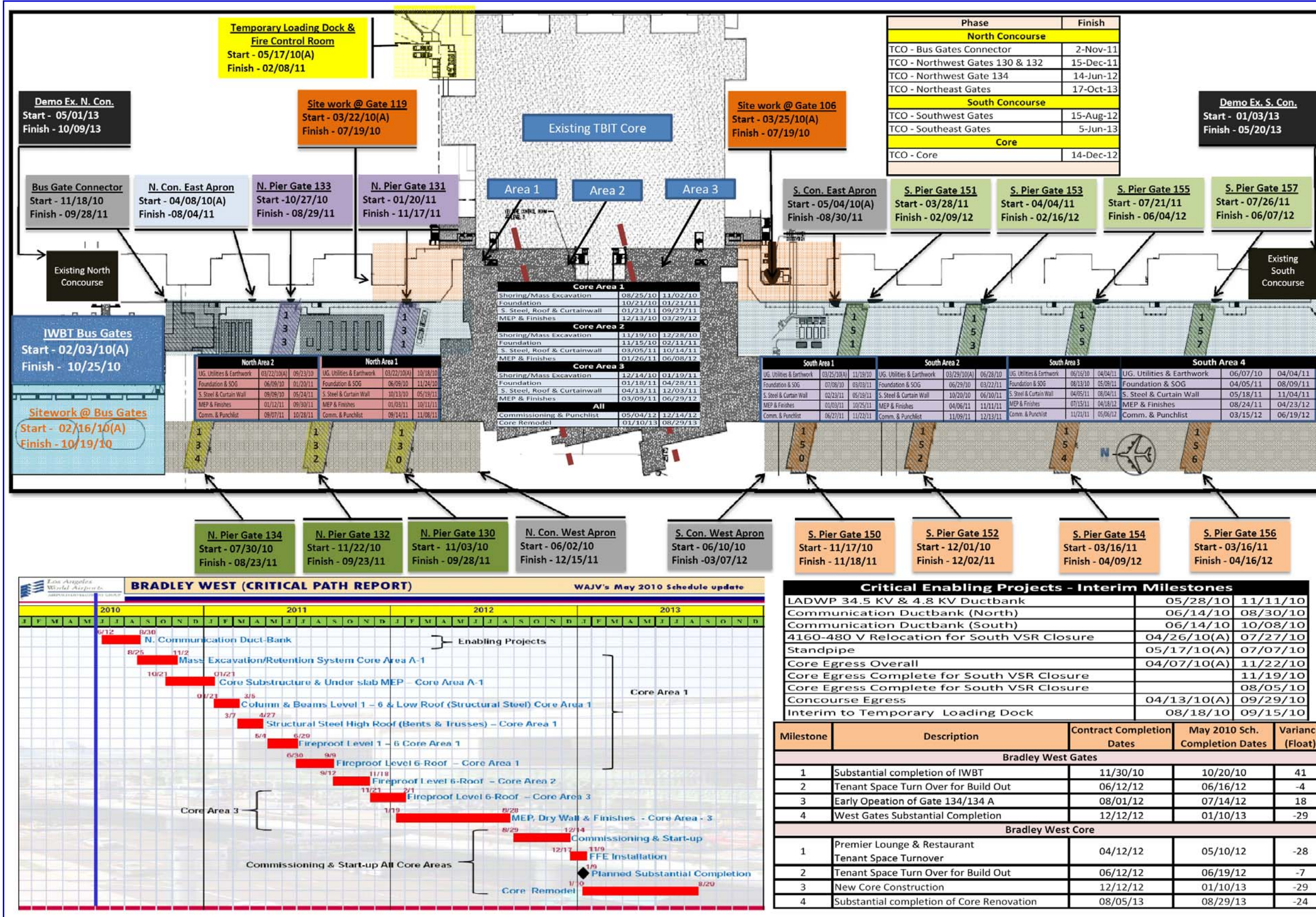

Bradley West Construction and Milestone Schedule

Below find highlights to the Schedule:

→ Yellow Box, Top Left: Temporary loading dock and fire alarm control building schedule.



→ Blue Box, Left Side: Interim West Busing Terminal (IWBT) scheduled completion. This project is tracking on-schedule and there may be an improvement to the completion date shown. Further updates will be provided each month.



→ Black & White List, Bottom Right: Critical Enabling Projects - Interim Milestones projects have been the focus of this newsletter with emphasis on shutdowns to the power and communication systems that impact TBIT Operations. The TBIT Community must be involved in the preparation of the work plans and schedule to minimize operational impacts.

Interim West Busing Terminal Update

Construction is taking shape on the new Interim West Busing Terminal (IWBT) at the northwest corner of TBIT adjacent to gate 123. This IWBT will be the temporary home of the TBIT busing operation until the Bradley West facility is complete. The existing bus gates need to be relocated to make way for the scheduled excavation of the Brad-

ley West Core. Both arrivals and departures will be accommodated in the new building. The rendering below represents the IWBT.

Similarly, a temporary loading dock is being constructed on the north side of TBIT to replace the current loading dock on the west side. However, this temporary

loading dock will not be completed in time to make way for the excavation and in order to maintain schedule, the IWBT will house an interim loading dock for approximately 4-5 months. The drawing at the bottom of the page illustrates this interim condition with the delivery truck, trash compactor, recycle bin and security access.

Interim West Busing Terminal (IWBT)



“Art has to move you and design does not, unless it’s a good design for a bus.”

--David Hockney
English Painter

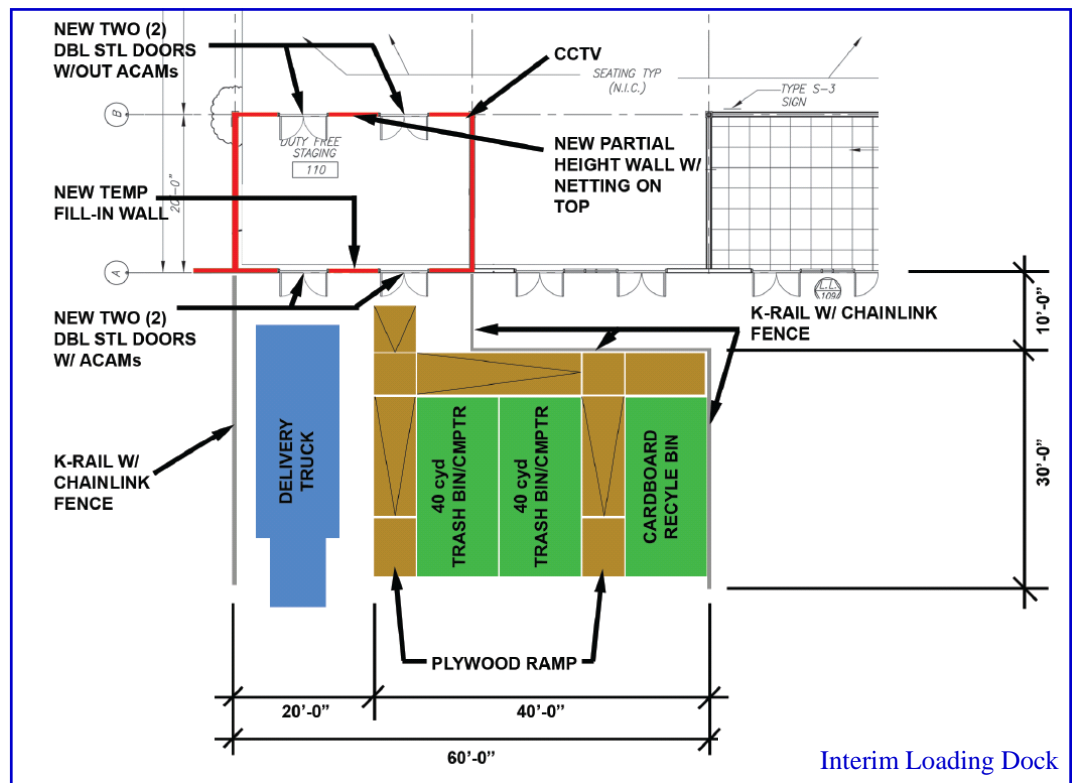

Interim Loading Dock

Gate 106 & 119 Progress

Gates 106 and 119 have been closed since March for major utility construction. The originally anticipated completion dates have slipped approximately 8 weeks. Two significant reasons for the schedule delays have been contaminated soil and inaccurate as-built drawings. Contaminated soil requires removal, testing, and remediation prior to proceeding. The inaccuracy of the original

TBIT drawings has uncovered utility conflicts resulting in re-designs and change directives. The contractor has had to re-excavate several times as well as hand dig causing significant extra work. Gate 119 is now scheduled for completion in late September with gate 106 to follow in October. Every effort shall be made to accelerate the schedule and minimize the gate closures.



Gate 119

In-Transit Lounge Impacts

Excavation for the Bradley West Core will displace Customs & Border Protection (CBP) offices on the west wall of TBIT. Therefore, a new CBP break room and enforcement office (see drawings below)

shall be constructed. Construction is scheduled to commence at the end of July. This is a temporary condition and once the Bradley West program is complete, this space shall be restored.

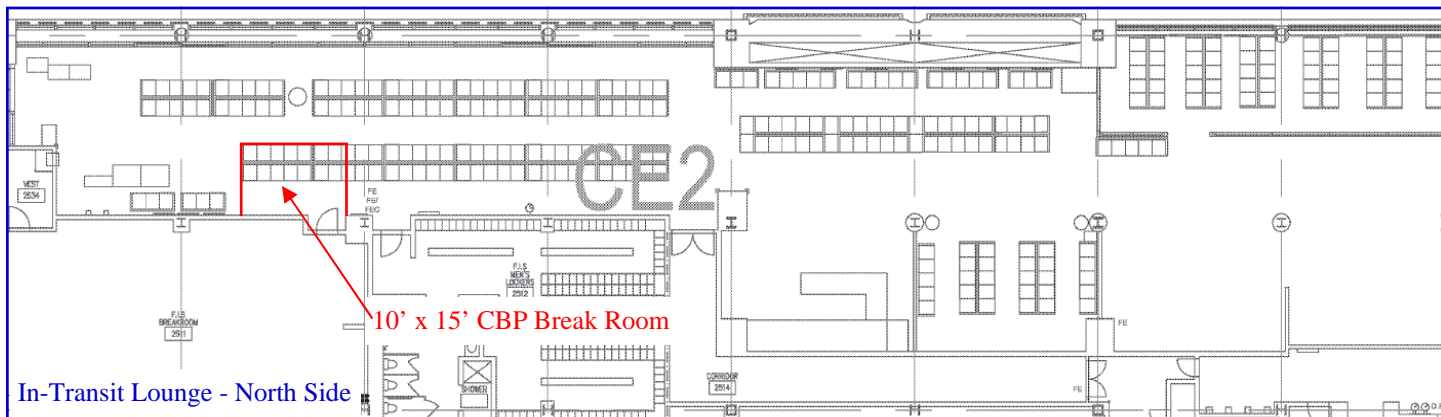

In-Transit Lounge - North Side

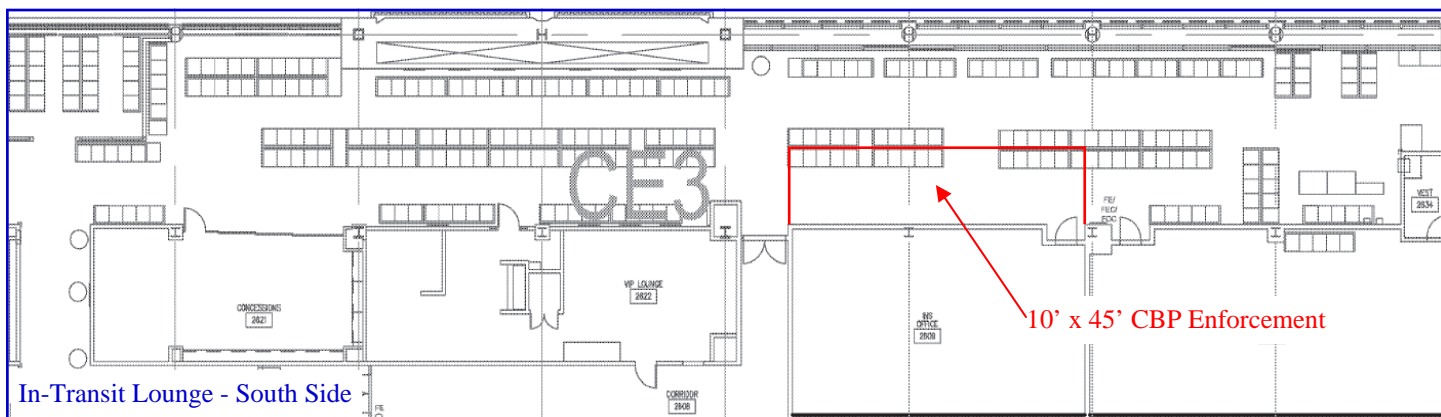

In-Transit Lounge - South Side

Construction Photographs

Construction Photographs Clockwise From Upper Left:

- North Concourse - Foundation Excavation
- North Concourse - Reinforcing Steel for Structural Foundations
- North Basement - Reinforcing Steel for Structural Foundations
- North Basement - Reinforcing Steel for Structural Foundations
- North Basement - Concrete Foundations & Structural Steel
- Interim West Busing Terminal - West Side
- Interim West Busing Terminal - South Side
- Gate 119 - Utility Construction



LAXTEC Corporation
380 World Way
Box S - 18
Los Angeles, CA 90045
Phone: 310 - 646 - 9378
Fax: 310 - 646 - 2981
SITA: VNYLXCR

Published for LAXTEC by:

AvAirPros