

In Transit Lounge

For the TBIT community, the memory of the TBIT Refurbishment Project and the operational challenges of working around phased construction still linger as the new Bradley West building progresses and the renovation in the existing building looms. One of the future challenges for areas of TBIT will be the renovation of the existing In Transit lounge. Two options to conduct this renovation have been studied for some time. Option 1 is to renovate the facility while the In Transit lounge was in use, requiring multiple construction phases and option 2 would relocate the function out of the space entirely to clear the way for reconstructing the space all at once.

Option 1

Renovation to be conducted while the lounge was in use would require 7 or more phases and up to a 12 month construction schedule.

Option 2

The only area with enough space to accommodate a temporary relocation of the In Transit lounge is the Interim West Bus Terminal (IWBT). The savings in construction time could be up to 6 months if option 2 was selected.

However, during the review process it was suggested that the airlines may be able to temporarily operate without an In Transit lounge. Several meetings were convened with those airlines that have a need for an In Transit lounge, KE, TQ, and possibly in the future NZ. AF also participated to provide their experience with In Transit flights.

After much discussion, it was agreed among all airlines that they could operate for a short period of time without an In Transit lounge. A formal request to temporarily eliminate the In Transit Lounge has been submitted to the regulatory agencies for approval. Final agreement and approval from the airlines, CBP, LAWA and the TSA is pending. Assuming that the temporary elimination of the In Transit function is approved the following key factors of operating an In Transit flight without an In Transit lounge are required:

- All In Transit passengers must be processed through CBP primary
- All In Transit passengers must be directed by the airlines to the new Central Core
- All In Transit passengers will then be free to move about the new Bradley West facility the same as any departing passenger. All passengers can shop and eat in the new concessions, walk down the concourses, enjoy the airline premium lounges or pass back through security out to the curb.

The enclosed insert graphically depicts the temporary In Transit passenger route from the new CBP primary area to the new Central Core.

The drawing below illustrates the renovated In Transit lounge upon completion of the Bradley West program. The renovated In Transit lounge will be located in the north end of the current In Transit lounge.

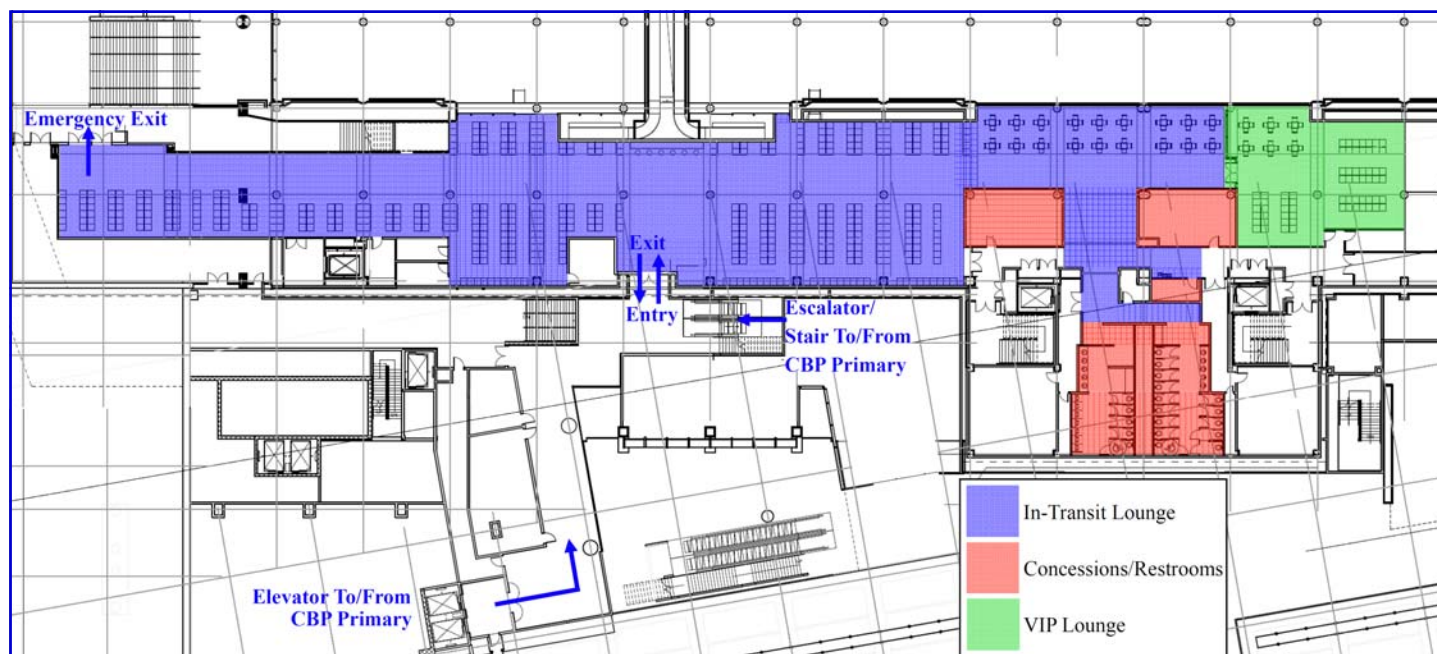

Central Core Construction



April 22, 2011



June 17, 2011



July 01, 2011



August 05, 2011



August 26, 2011



September 02, 2011