

Central Core Level 4 Amenities

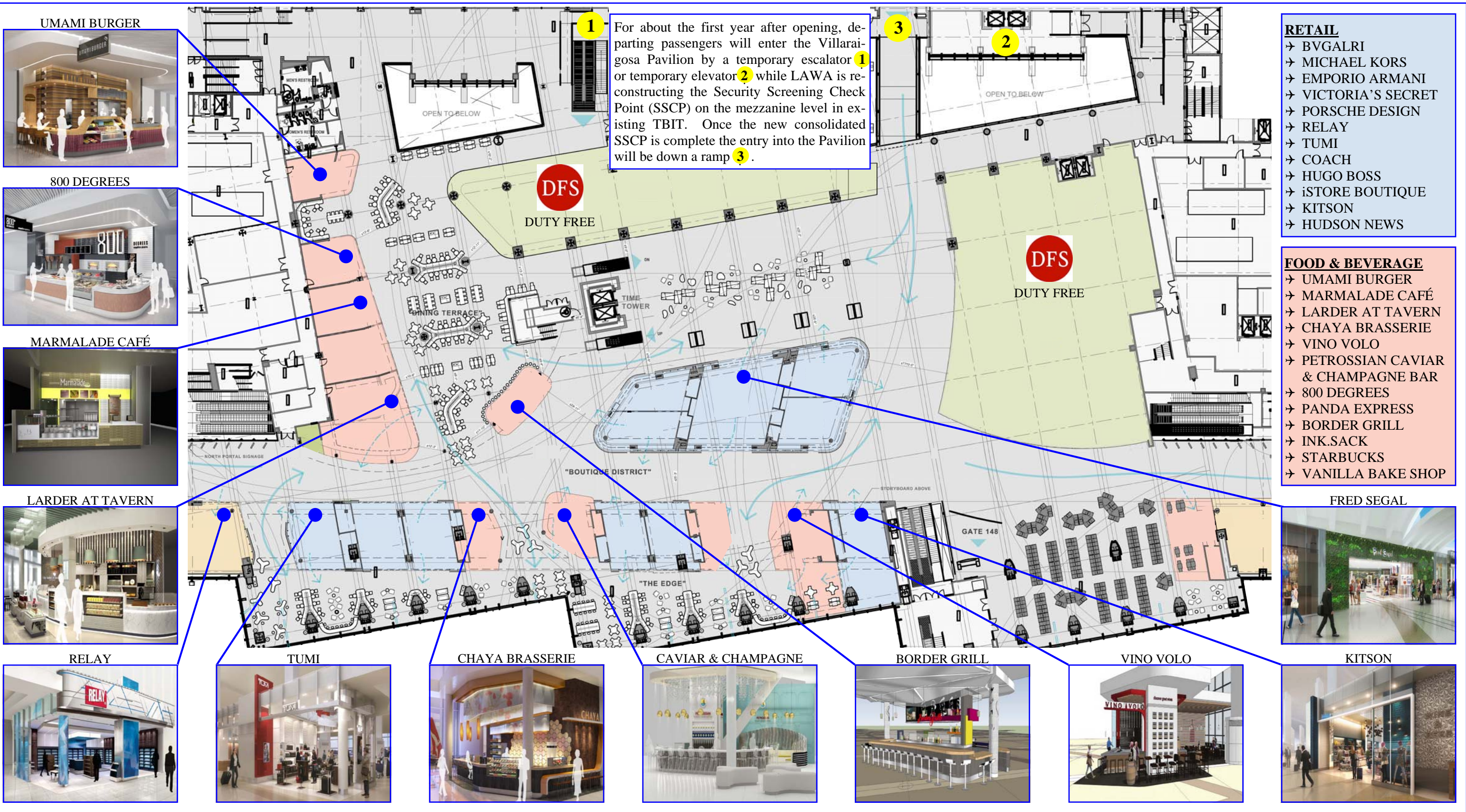

- RETAIL**
- BVGALRI
 - MICHAEL KORS
 - EMPORIO ARMANI
 - VICTORIA'S SECRET
 - PORSCHE DESIGN
 - RELAY
 - TUMI
 - COACH
 - HUGO BOSS
 - iSTORE BOUTIQUE
 - KITSON
 - HUDSON NEWS

- FOOD & BEVERAGE**
- UMAMI BURGER
 - MARMALADE CAFÉ
 - LARDER AT TAVERN
 - CHAYA BRASSERIE
 - VINO VOLO
 - PETROSSIAN CAVIAR & CHAMPAGNE BAR
 - 800 DEGREES
 - PANDA EXPRESS
 - BORDER GRILL
 - INK.SACK
 - STARBUCKS
 - VANILLA BAKE SHOP

Central Core Level 5 Amenities

FOOD & BEVERAGE

- III FORKS STEAKHOUSE
- DRINKS L.A.
- LUCKY FISH

DRINKS L.A.



III FORKS STEAKHOUSE



LUCKY FISH

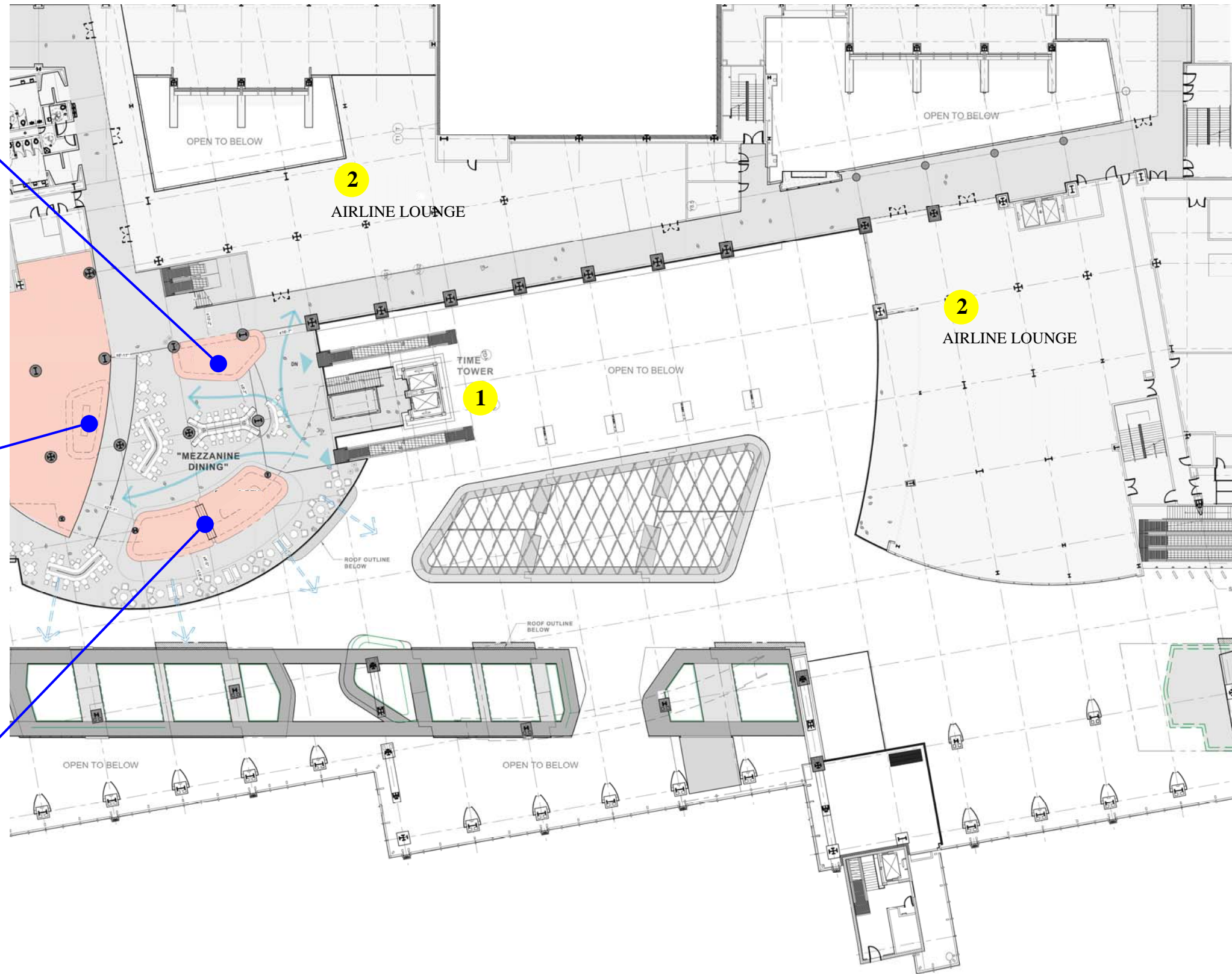
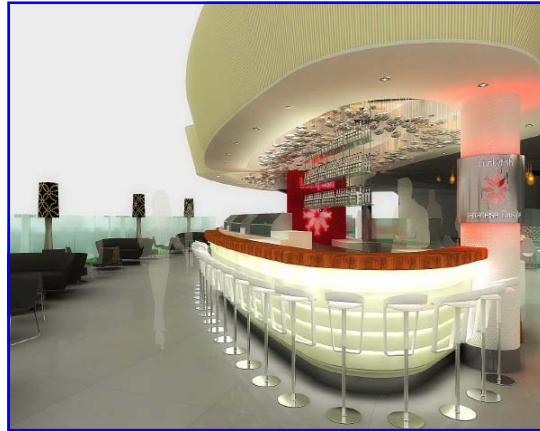

The main access to level 5 is located at the new featured 'Time Tower' **1** that houses a pair of elevators. In addition to the elevators, two escalators and a staircase wrap around the Time Tower structure. The restaurants at this level will offer a dining experience that simply does not currently exist at TBIT or LAX for that matter. In addition to fine dining options, there is an interior terrace that overlooks the Pavilion and will have a great view of the electronic media displays. Two airline lounges **2** in the new facility will also be located on this level.