

# CONSTRUCTION HOT TOPICS

## #1 CENTURY BLVD LANE CLOSURES MAY 18 - 19

TO FACILITATE WORK FOR THE APM PROJECT, AN OVERNIGHT CLOSURE OF UP TO TWO EASTBOUND LANES ON CENTURY BLVD BETWEEN THE LAX EXIT RAMP AND AVION DR IS SCHEDULED THIS WEEKEND: SAT., MAY 18 AT 7PM THROUGH SUN., MAY 19 AT 9AM. SIGNAGE AND FLAGGERS WILL BE DEPLOYED.

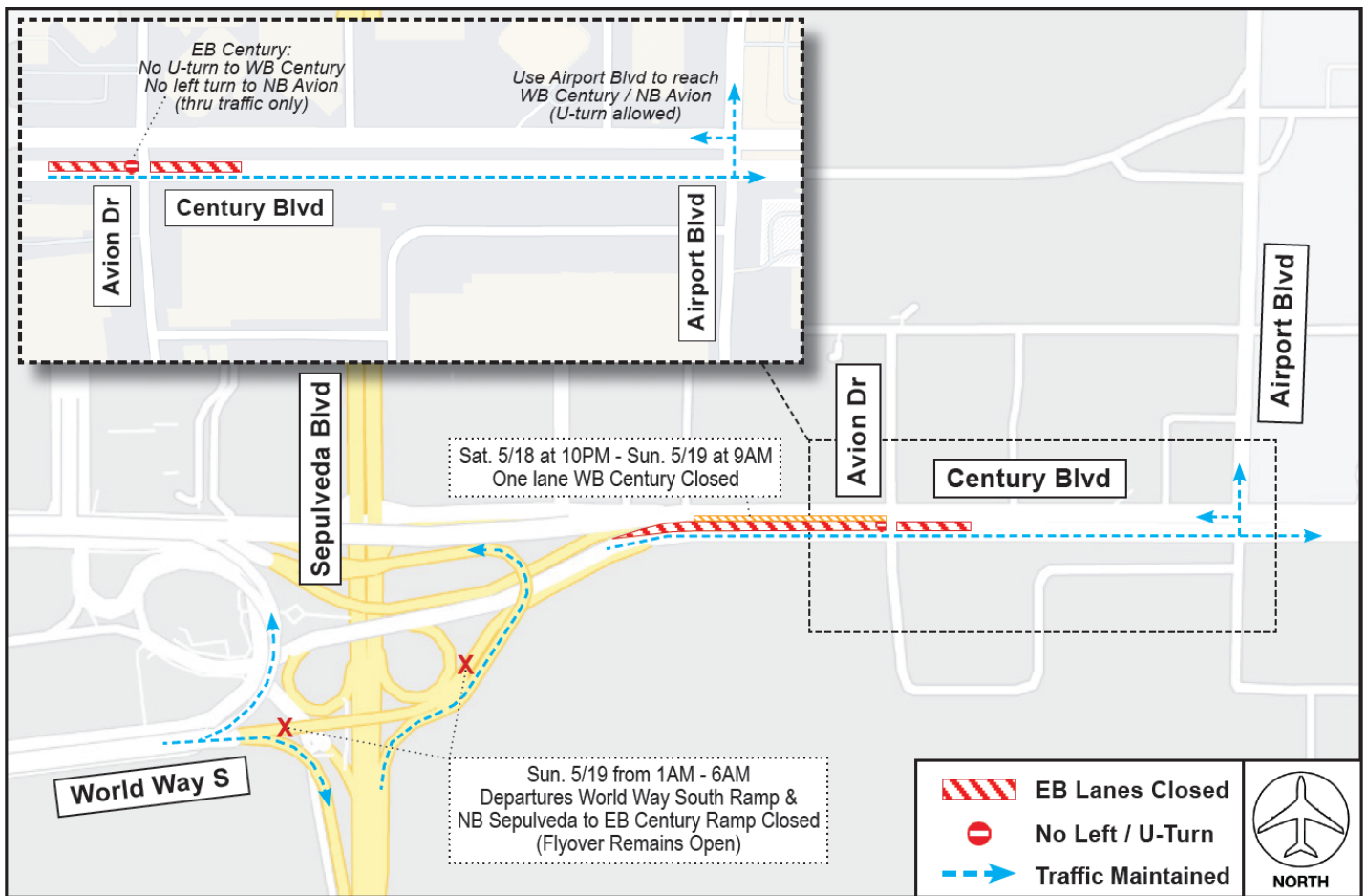

### PLEASE NOTE:

Through traffic in both directions, including access to and from LAX, will be maintained at all times.

LAX Construction Hotline: 310-649-5292 | LAXConstructionHotline@LAWA.org



flyLAX.com

@flyLAXairport

LAInternationalAirport



# CONSTRUCTION HOT TOPICS

## #2 TERMINAL 6 AIRLINE GATES RE-OPENING

THE FOLLOWING ARE SCHEDULED DATES  
FOR AIRLINE GATES RE-OPENING IN  
TERMINAL 6 IN APRIL & MAY 2024:

GATE 61: MAY 13 (CLOSED AUGUST 2021)

GATE 65B: MAY 13 (CLOSED JUNE 2023)

### PLEASE NOTE:

Airline gate closures are in place to facilitate various construction activities for the Alaska Airlines Terminal 6 Redevelopment Program. Passenger holdrooms and seating areas remain available throughout the terminal.

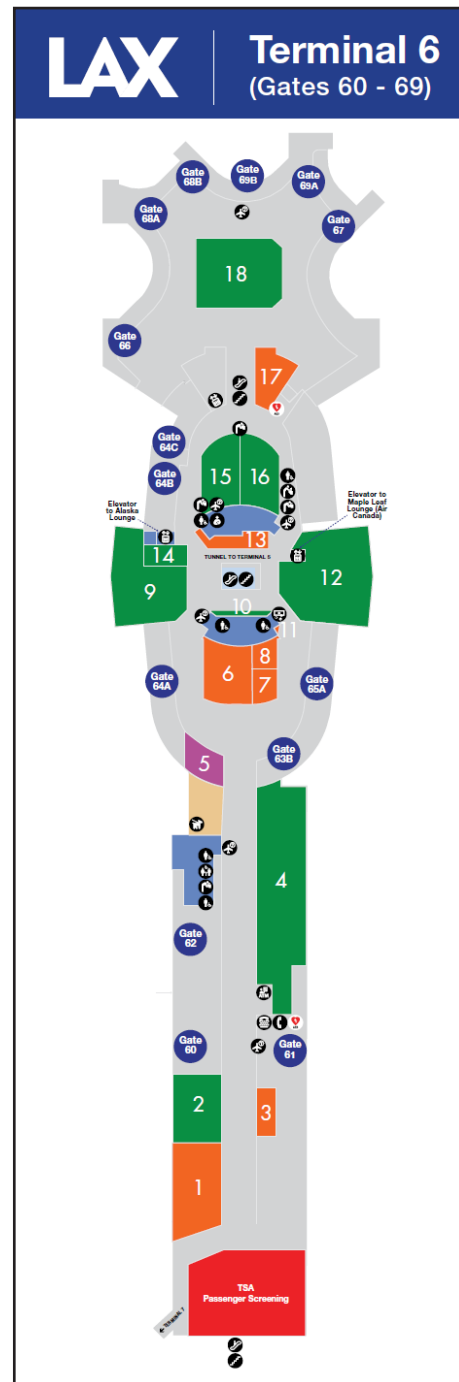

LAX Construction Hotline: 310-649-5292 | LAXConstructionHotline@LAWA.org



flyLAX.com

@flyLAXairport

LAInternationalAirport



# CONSTRUCTION HOT TOPICS

## #3 RAMP & LANE RESTRICTIONS: I-405 AND LA CIENEGA BLVD MAY 17 - 20

TO FACILITATE WORK FOR THE ROADWAY AND UTILITY ENABLING PROJECT, THE FOLLOWING ARE SCHEDULED TO BE CLOSED FRIDAY, MAY 17 AT 11PM CONTINUOUS THROUGH MONDAY, MAY 20 AT 6AM:

SOUTHBOUND I-405 RAMPS:

WEST RAMP - BOTH OFF AND ON RAMPS CLOSED (INCLUDING COLLECTOR DISTRIBUTOR ROAD)

EAST RAMP - OFF RAMP CLOSED; ON RAMP REMAINS OPEN

LA CIENEGA BLVD: FULL CLOSURE BETWEEN CENTURY BLVD AND ARBOR VITAE ST FOR PAVING ACTIVITY.

### PLEASE NOTE:

Access to local businesses will be maintained at all times. Detour signage will be posted.

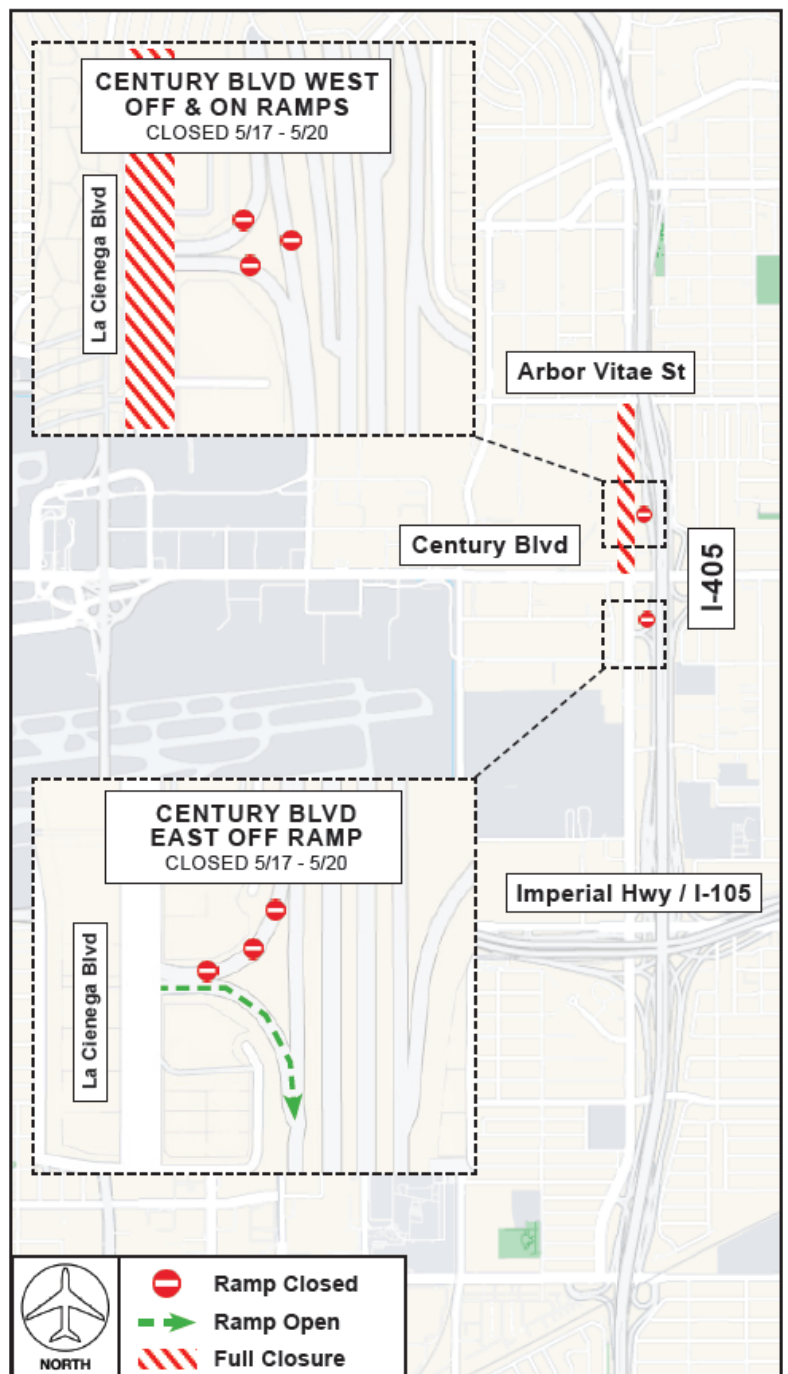

LAX Construction Hotline: 310-649-5292 | LAXConstructionHotline@LAWA.org



flyLAX.com

@flyLAXairport

LAInternationalAirport



# CONSTRUCTION HOT TOPICS



## #4 MAY 2024: CTA LANE RESTRICTIONS

THE MAP BELOW IS A COLLECTIVE SNAPSHOT OF ALL SCHEDULED 24/7 LANE RESTRICTIONS FOR CTA DEPARTURES AND ARRIVALS LEVEL ROADWAYS FOR THE MONTH OF MAY 2024.

### PLEASE NOTE:

This map only reflects 24/7 continuous lane closures in the CTA; other nightly lane closures / sidewalk restrictions may be in place to facilitate construction activities

### ACCESS MAINTAINED:

Traffic around the Central Terminal Area will be maintained at all times, as well as access to passenger pick-up and drop-off

### PLAN AHEAD:

Motorists should plan ahead for potential delays

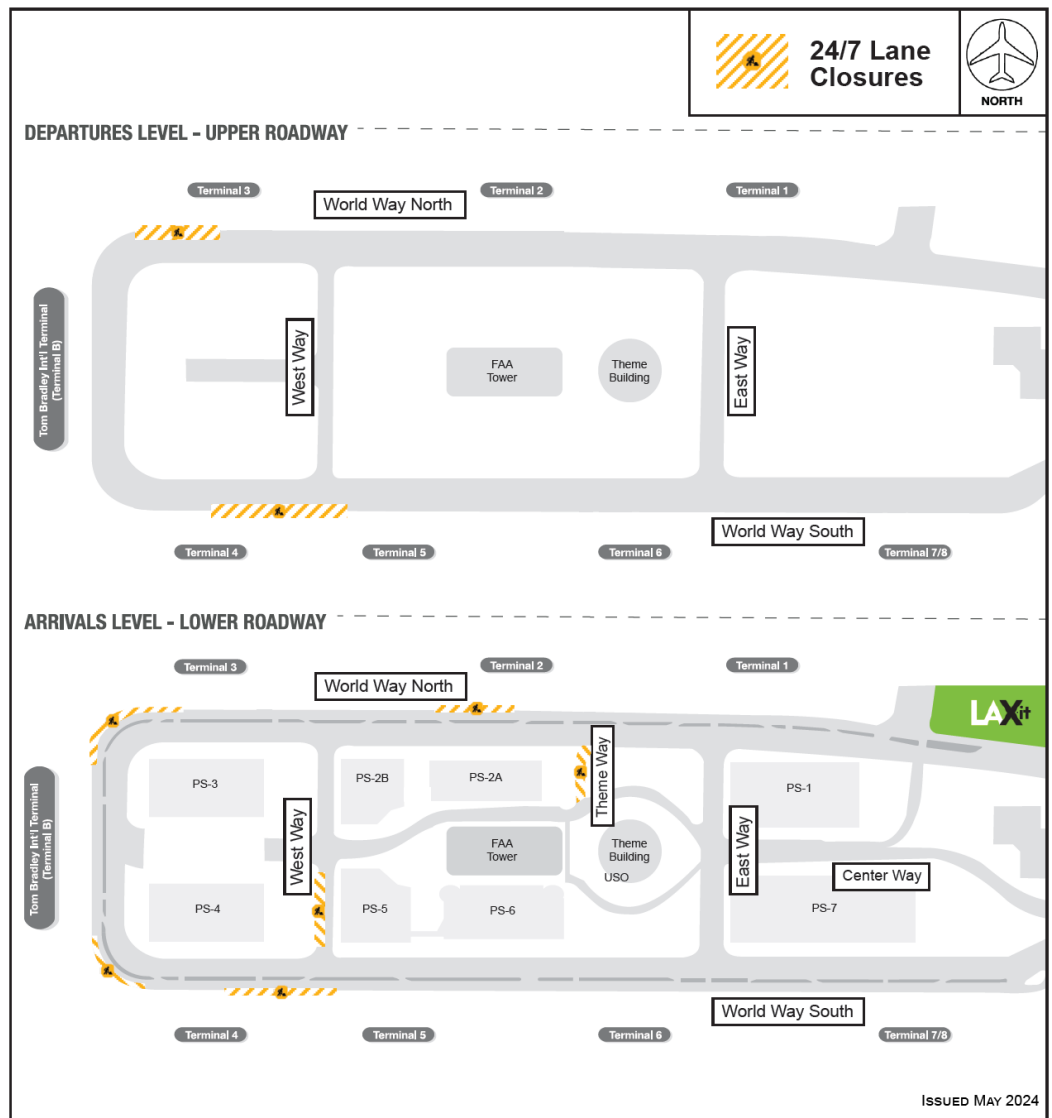

LAX Construction Hotline: 310-649-5292 | LAXConstructionHotline@LAWA.org



flyLAX.com

@flyLAXairport

LAInternationalAirport

